

# FETE 3mx3m

## Assembly Instructions

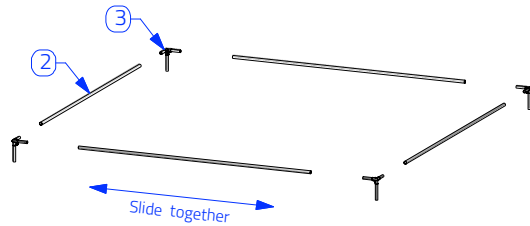

1. - Assemble corner fittings and Alloy eave tube in 3x3 square.

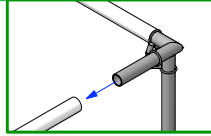

2. - Attach brace cables over corner fitting hook.  
- Lift last corner for top wire.

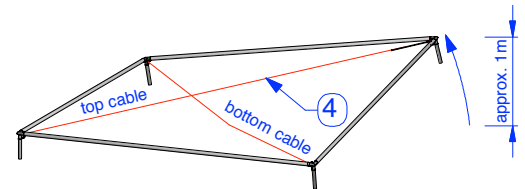
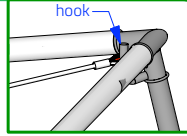

3. - Fit roof fabric over assembled frame.

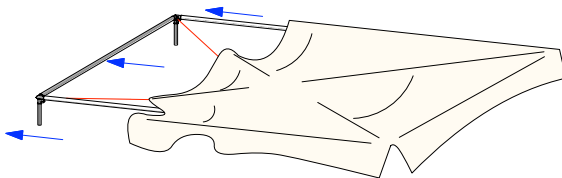

4. - Pull web loop over each corner fitting lug.

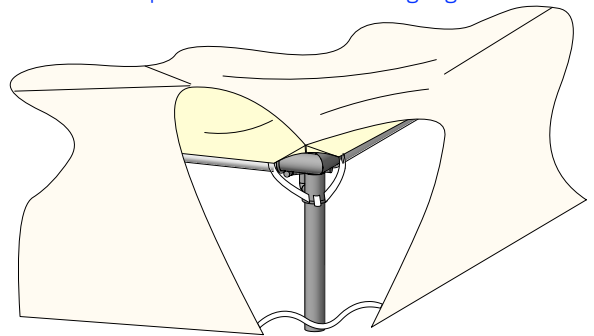

5. - Button lock base fitting to leg alloy  
- Raise side onto legs with erecting fork at centre of eave.  
- Hook web straps to base fitting loop.

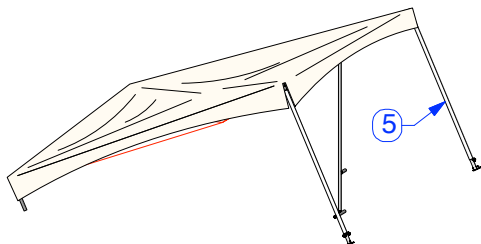
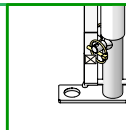

Recommend :Strong man lift with fork and others insert legs

6. - Insert centre pole cap into roof apex  
- roll centre pole on top cable to the centre where cables cross  
- pull lower cable under to lock into centre pole roller fitting

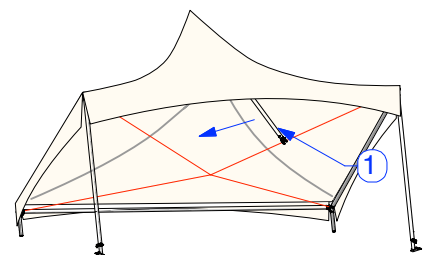
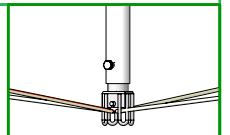

7. - Raise onto legs with erecting fork at centre of eave.  
- Secure straps to base feet  
- Tension corners evenly with straps.

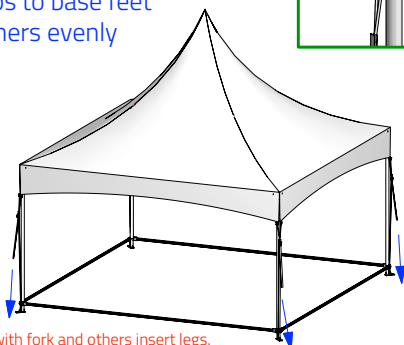
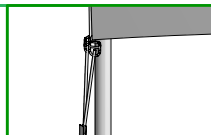

Recommend :Strong man lift with fork and others insert legs.

8. - Peg base feet to ground  
- Base alignment for base rails outside.

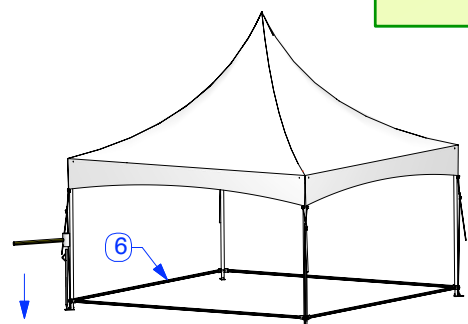
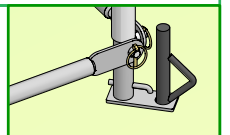

Fete marquees must be securely fixed down at all times.  
Minimum hold down force for each leg is 250kgs.

Baytex  
Ph: 07 579 0190  
info@baytex.co.nz